

How to activate software on SimPad using a license key

This document describes how to enable the SkillReporter software on a SimPad:

- With SimPad connected to Internet (Online Registration)
- With SimPad not connected (Offline registration)

(the process per se, is the same if you want to activate the Simulation software on a SimPad with the SkillReporter software pre-installed)

January 2014

You need to have the SimPad software version 1.7.5.17821 or newer (higher number) to be able to enable software by a license key.

Go to System Settings and “About SimPad” to see the view below:

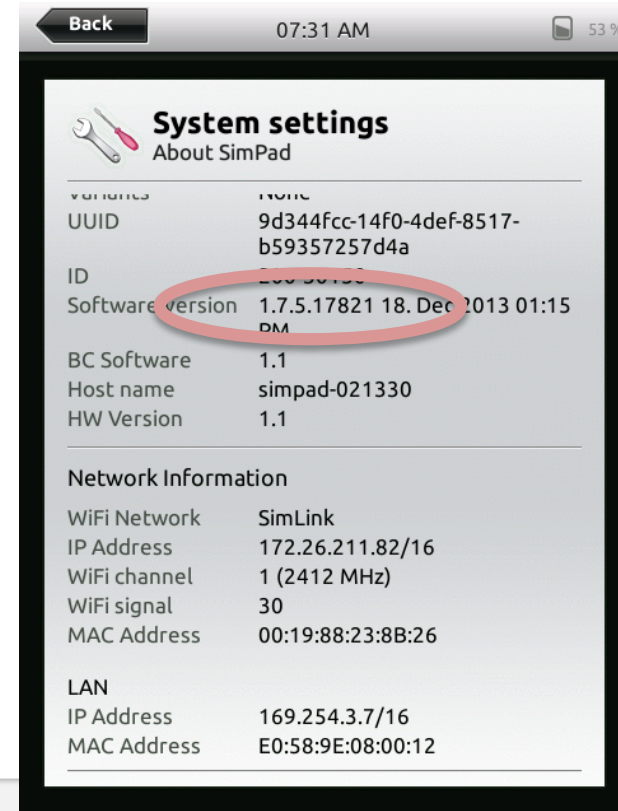
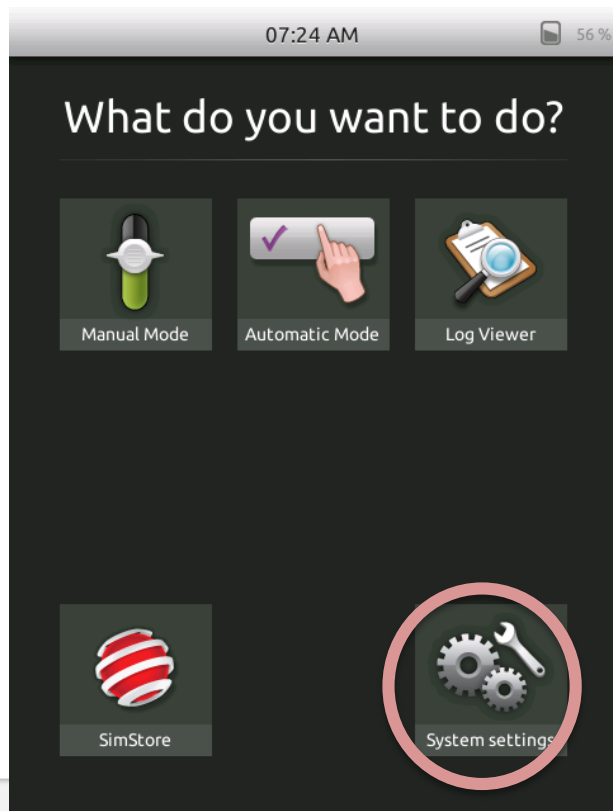

- If you have the SimPad software version 1.7.5 or you can purchase a license and enable the SkillReporter software on your SimPad
- The SkillReporter software license is available at this location:
<http://www.laerdal.com/doc/2419/SimPad-SkillReporter#/Webshop/LICENSES>
- Your welcome screen will look like this before the SkillReporter software is enabled:

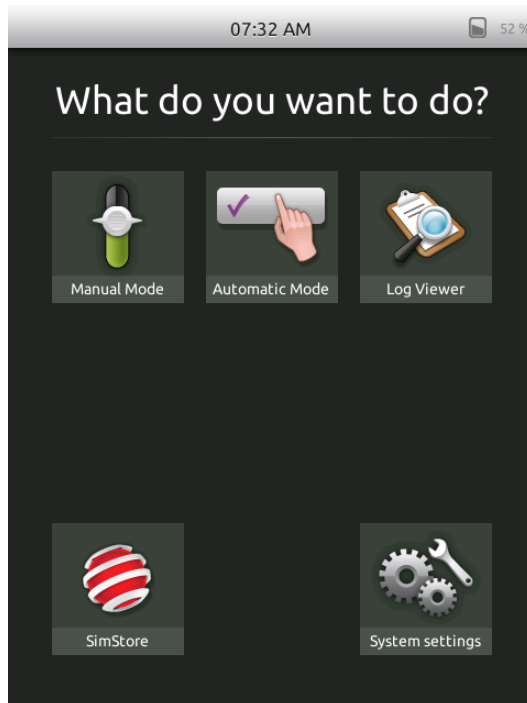

The following slides shows how to activate the SkillReporter software using a license key.

Connect your SimPad to Internet, using a network cable (allowing the SimPad to connect with Internet takes a few seconds)

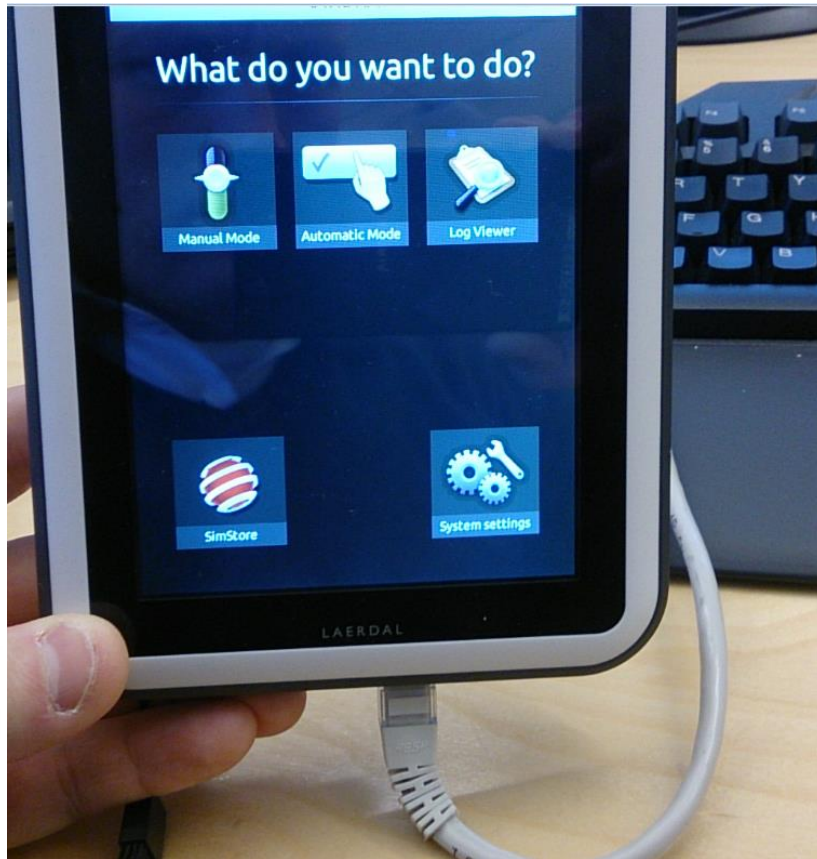

Go to “System Settings”

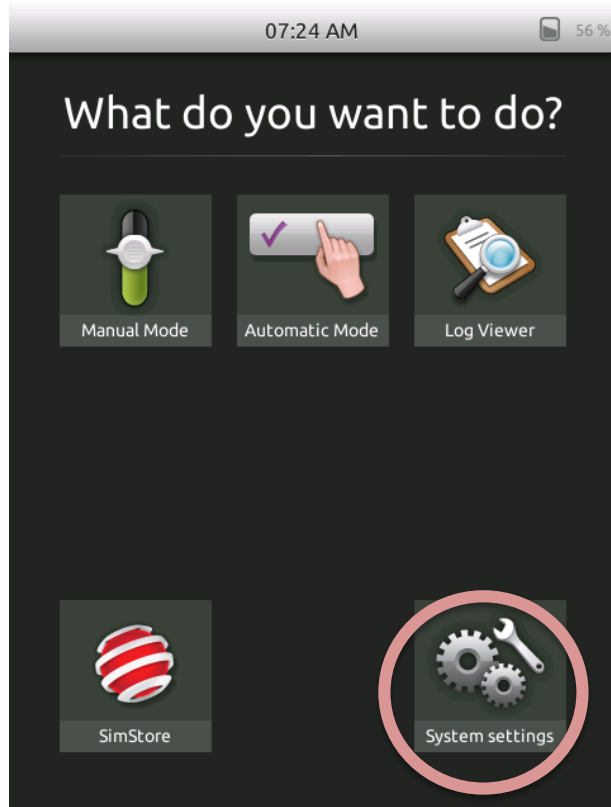

Go to “Licenses”

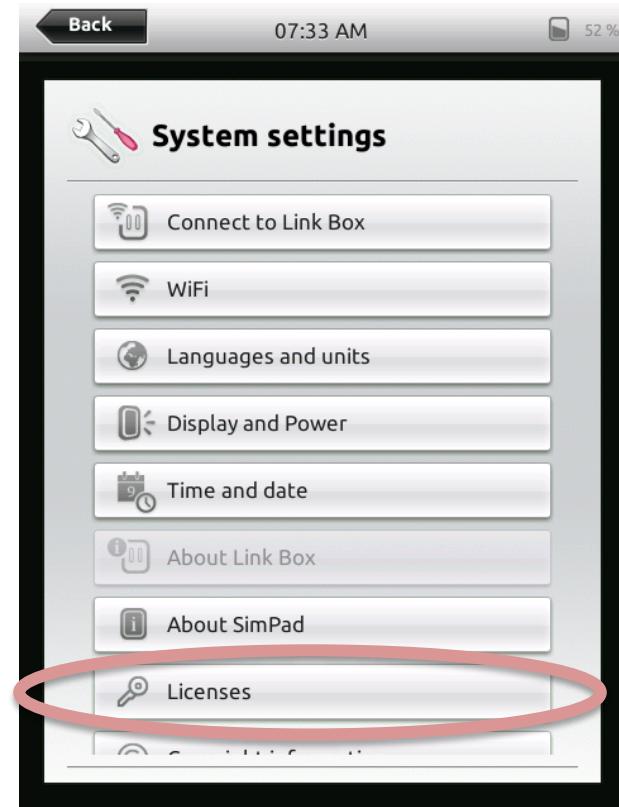

Press “Add New License”:

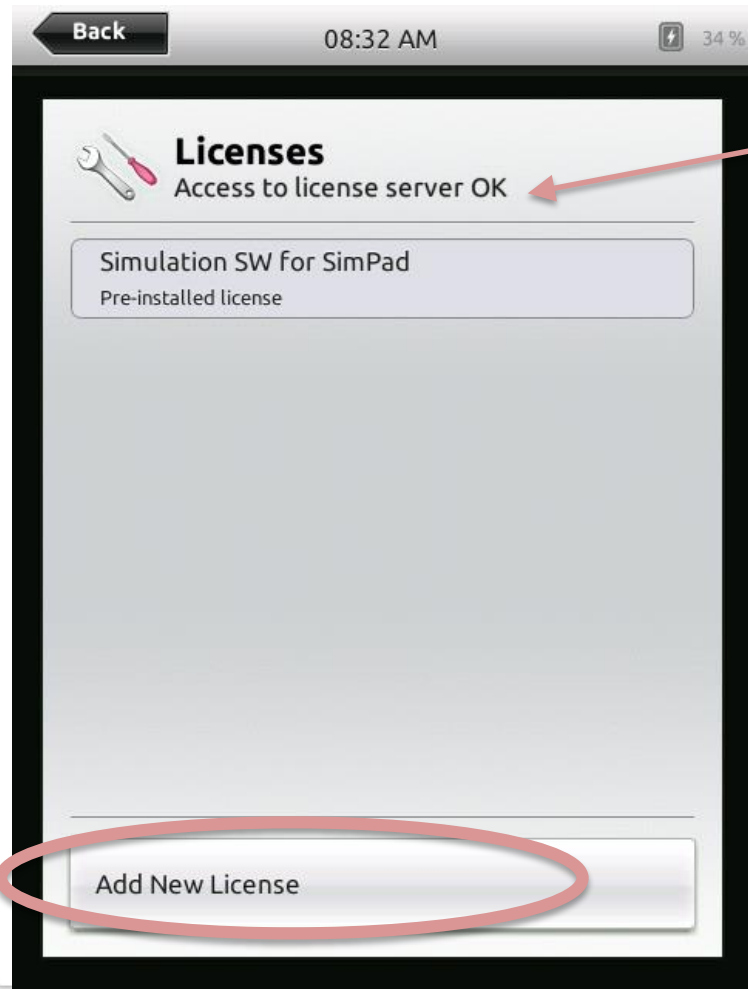

Make sure Access to license server is OK.

If you are not able to access the license server, see how to register in offline mode.

Enter your license key:

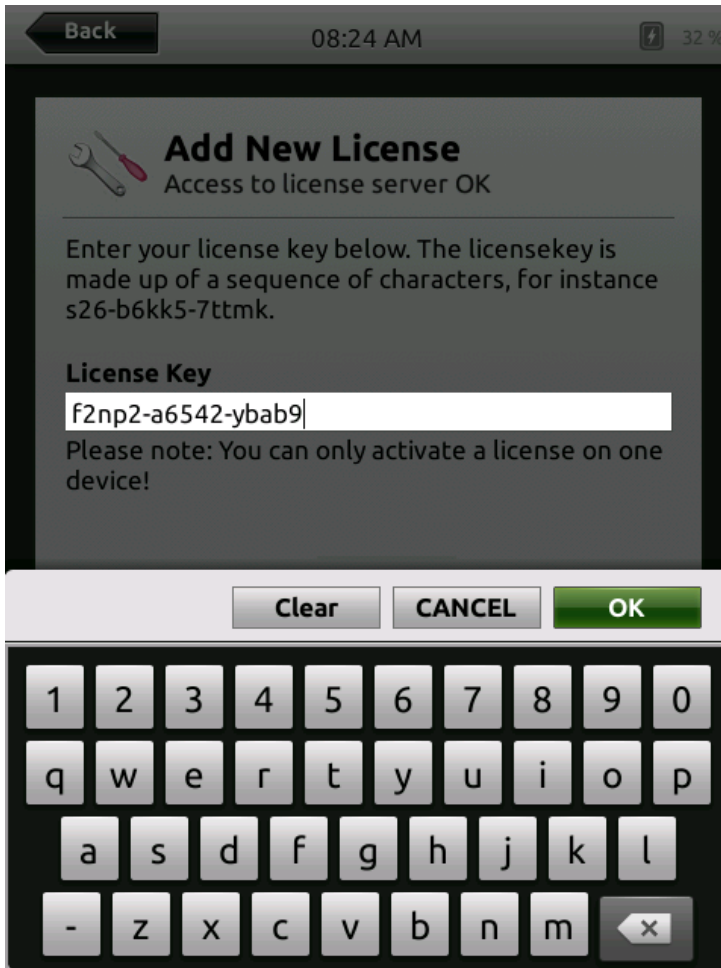

The screenshot shows a mobile application interface with a dark background. At the top, there is a 'Back' button, the time '08:24 AM', and a battery icon showing '32%'. The main content area is titled 'Add New License' with a wrench and screwdriver icon. Below the title, it says 'Access to license server OK'. A paragraph of text explains that the license key is a sequence of characters, with an example 's26-b6kk5-7ttmk'. A text input field is labeled 'License Key' and contains the text 'f2np2-a6542-ybab9'. Below the input field, there is a note: 'Please note: You can only activate a license on one device!'. At the bottom of the screen, there are three buttons: 'Clear', 'CANCEL', and 'OK'. Below the buttons is a virtual keyboard with letters, numbers, and a backspace key.

Back 08:24 AM 32%

Add New License
Access to license server OK

Enter your license key below. The licensekey is made up of a sequence of characters, for instance s26-b6kk5-7ttmk.

License Key
f2np2-a6542-ybab9

Please note: You can only activate a license on one device!

Clear CANCEL OK

1 2 3 4 5 6 7 8 9 0
q w e r t y u i o p
a s d f g h j k l
- z x c v b n m ↵

You now have the SimPad SkillReporter SW for SimPad installed.



Your start up screen now has the two icons BLS Learner and BLS Instructor.

Enjoy!

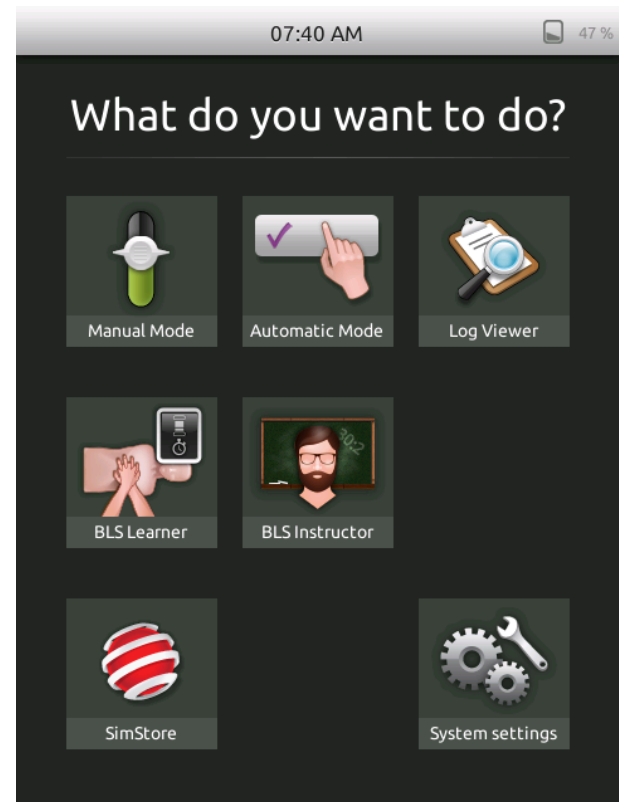



Laerdal
helping save lives

The next pages show the registration process for off-line registration.

Go to “System Settings”

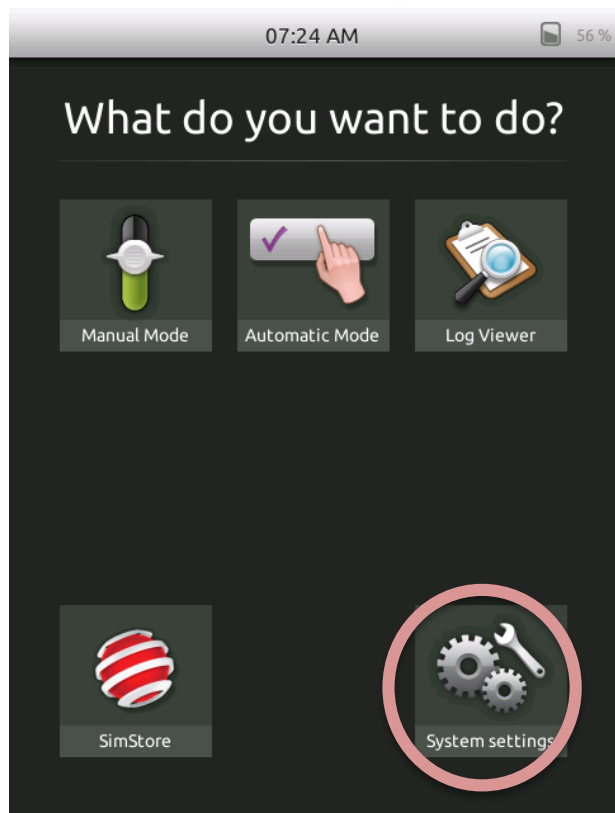

Go to “Licenses”

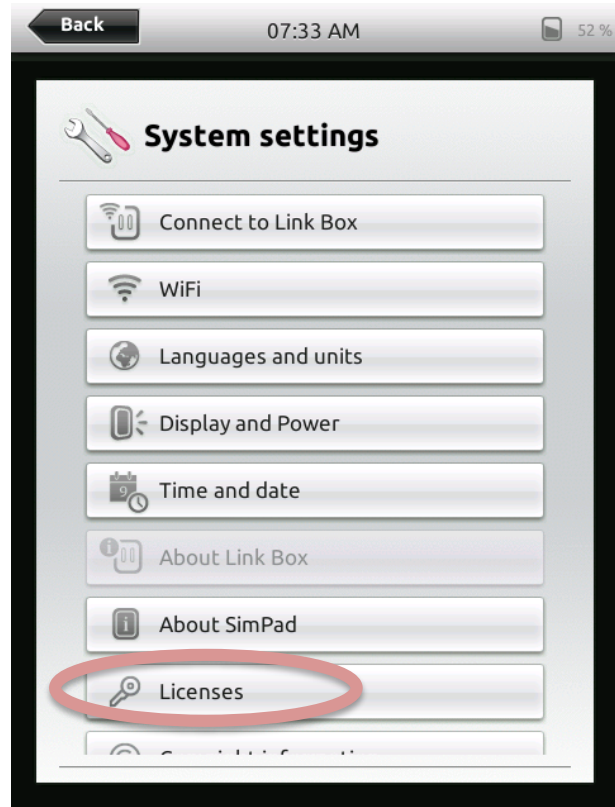

Press “Add New License”:

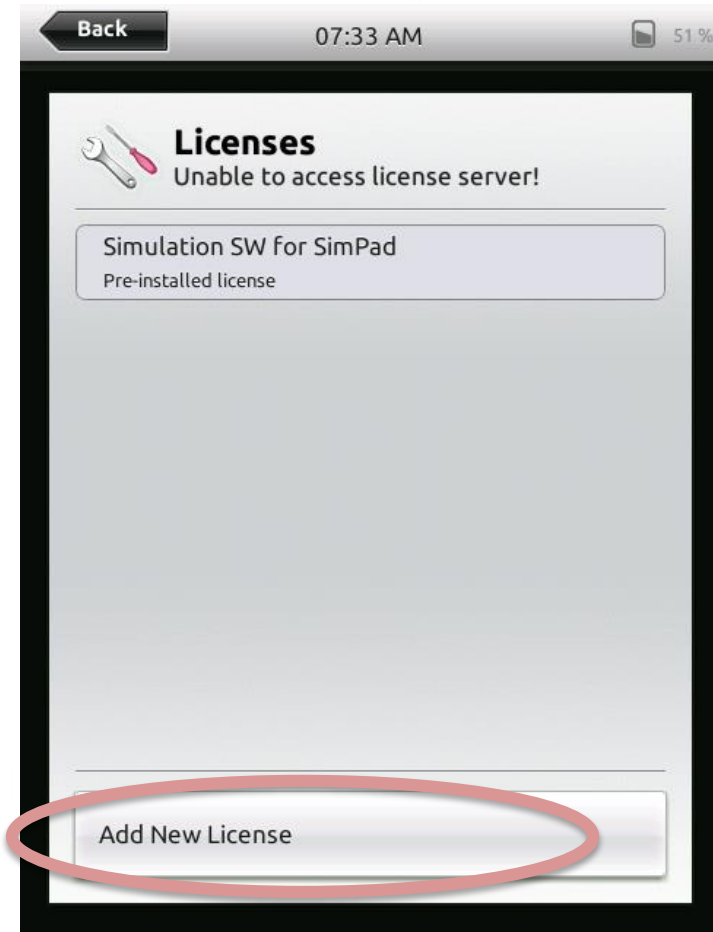

Enter the license key that you received from Laerdal when you purchased the software license (a virtual keyboard appears) and press OK.

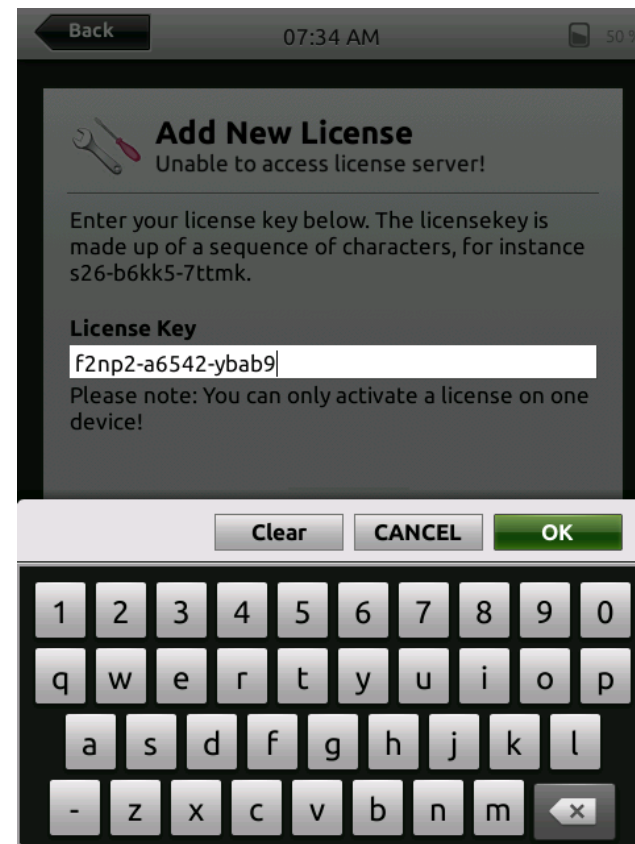

To activate the license on the Internet, go to this address (www.Laerdal.com/certificate/activate.aspx) and write the key shown on your SimPad and press OK on your PC. "Your activation result" is shown.

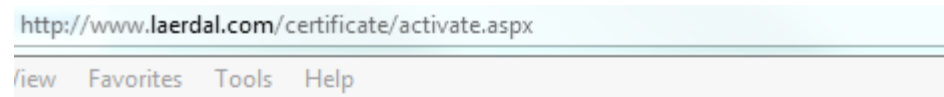
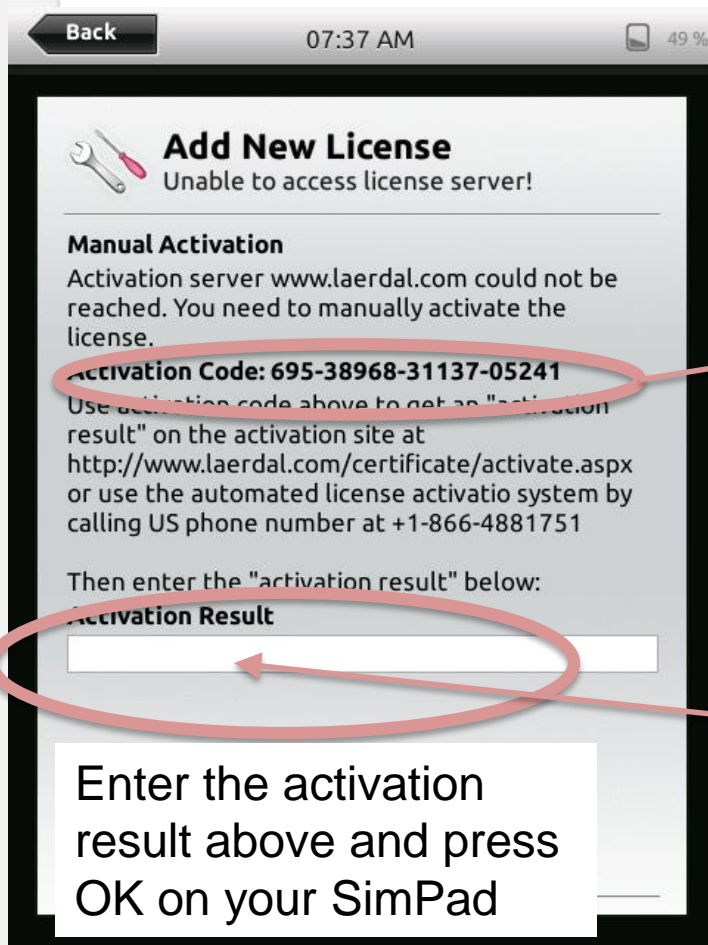

Activation

SimMan, HeartCode, Heartsaver, MicroSim, ALS, Scenar

Code:

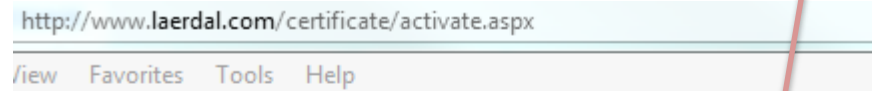

Activation

SimMan, HeartCode, Heartsaver, MicroSim, ALS, S

Your activation result is: 2-27832-12872

You now have the SimPad SkillReporter SW for SimPad installed.

Your start up screen now has the two icons BLS Learner and BLS Instructor.

Enjoy!

